

Leading light

White cabinetry and variable lighting make the Grants' stunning kitchen the focal point of their Georgian home

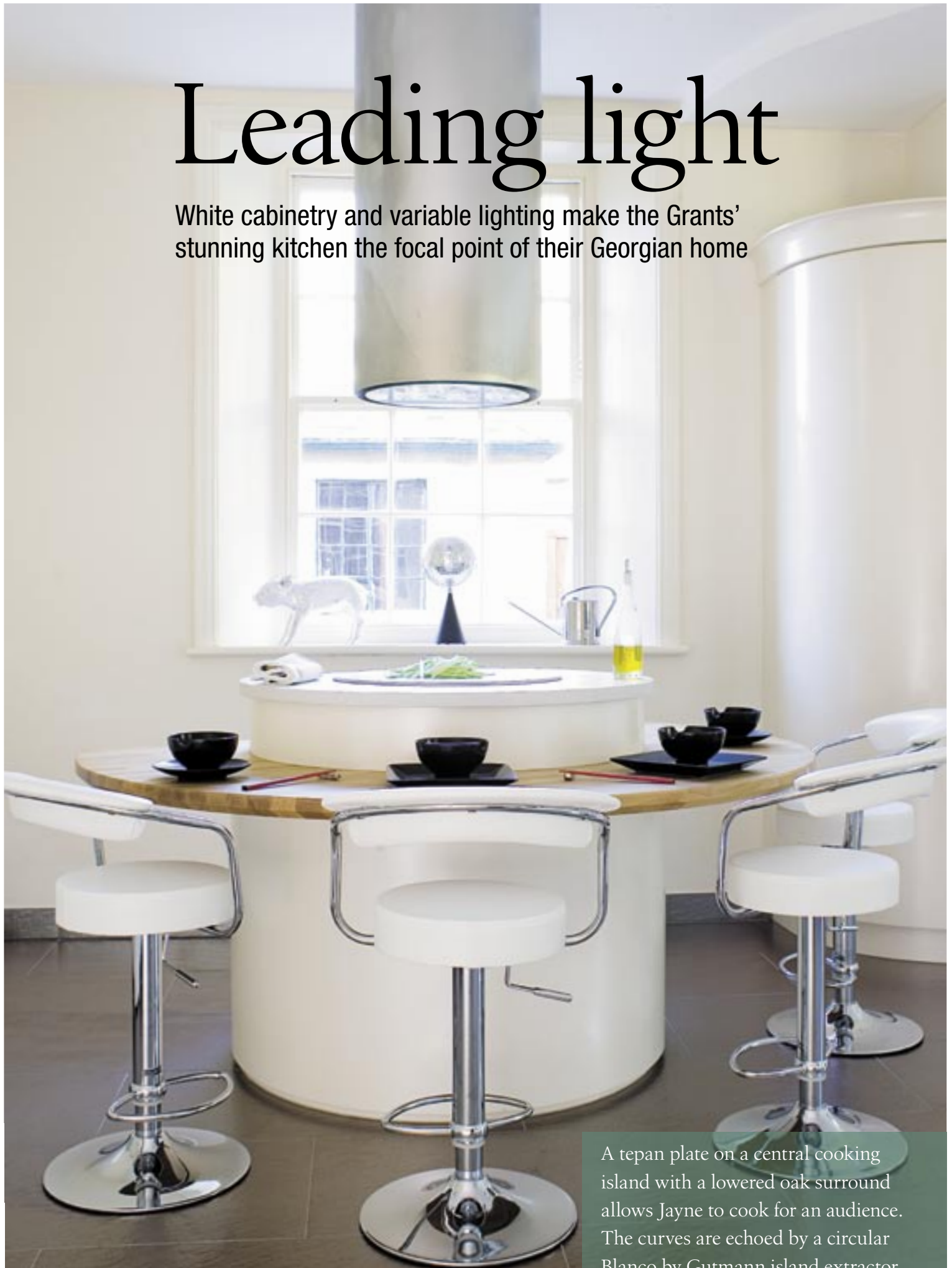

INNOVATIVE

A tepan plate on a central cooking island with a lowered oak surround allows Jayne to cook for an audience. The curves are echoed by a circular Blanco by Gutmann island extractor



As a colour therapist, Jayne Grant understood how effective different shades could be when it came to redesigning her kitchen. 'It was important that my home would be a reflection of what I practise professionally,' explains Jayne.

Like the other rooms in their newly acquired Georgian house, Jayne and husband Kieran's kitchen needed extensive work to bring it up to date. Looking at the building's layout, they quickly realised that the kitchen would be better sited in a different part of the property. Enthused by the potential of a larger space, Jayne began to consider how her dream kitchen might look. 'I approached half a dozen designers with a wish list as long as my arm,' she laughs. 'I wanted our kitchen to be capable of enhancing our own wellbeing. For me, that meant being able to change the colour at the flick of a switch.' Despite Jayne's specific guidelines, she was surprised to find that the designers she met completely disregarded them. 'Except for Max Spenser-Morris at Design Republic,' Jayne adds with a sigh of relief. 'He was receptive to my proposals and assured me that he could achieve the look that I wanted.'

A design emerged that encompassed Jayne's ideas and developed them into a luminous, sweeping scheme of spray-lacquered cabinetry that was devoid of any harsh angles. The couple chose an array of multifunctional appliances to punctuate the furniture and a curved teppan bar creates an impressive focal point.

'Our new kitchen is a joy to use,' enthuses Jayne. 'It's lovely to hear our friends speak admirably of it – visitors are always so impressed.'



Behind the main teardrop-shaped island, a bank of floor-to-ceiling cabinets features a clever configuration of cooking appliances that includes two multifunction ovens, a steam oven and a coffee machine. Overhead, an intricate network of recessed spotlights has been integrated into the stepped ceiling to maintain the feeling of light that Jayne wanted in the room

The couple wanted to replace the harsh corners, straight lines and right angles of their previous kitchen with gentle contours and curved cabinetry to create a graceful, fluid scheme. Underfoot, Platinum porcelain floor tiles that were sourced by Design Republic act as a contrast to the purity of the bespoke white furniture, while a smaller island provides Jayne and Kieran with extra storage space for crockery and glasses



'I am so pleased that our new kitchen is capable of enhancing our wellbeing'



At night, the Grants' kitchen takes on a different feel as coloured lights emanate from above and below the furniture. 'I can choose a scheme to suit my mood,' explains Jayne. 'Sometimes I'll sit down to flick through combinations until I find one that grabs me. Our guests love to play with the controls, too.' The couple often entertain so as well as several ovens to choose from, their island boasts a gas wok burner for speedy suppers





To maintain the kitchen's curved design, Jayne and Kieran opted for a Futura extractor from Blanco by Gutmann. When not in use, it glides out of sight, concealed below the island

THE KITCHEN FILE

DESIGN & CABINERY

- Max Spenser-Morris at **Design Republic**, Balaton Place, Snailwell Rd, Newmarket, Suffolk CB8 7YP (01638 676750) www.design-republic.net
- Bespoke spray-lacquered MDF cabinetry

WORKTOPS

- Bianco Rughe granite. Price per sq m **£400**
- Solid oak. Price per sq m **£300**

SINKS & TAPS

- BlancoClarox 513508 500-U undermounted single-bowl sink in stainless steel, Blanco **£423**
- BlancoRondo 513306 undermounted single-bowl prep sink in stainless steel, Blanco **£151**
- 2 x 10121103 Eve monobloc mixer taps with pull-out rinses in stainless steel, KWC, each **£468**
- 2 x ISE65 waste disposal units, In-Sink-Erator, each **£238**

APPLIANCES (shown)

- 2 x H4271BP built-in multifunction ovens, Miele, each **£850**
- H4020BM built-in microwave, Miele **£1,080**
- DG4060 built-in steam oven, Miele **£1,310**
- KM417 four-burner gas hob, Miele **£680**
- KM405 domino gas hob, Miele **£390**
- KM406 domino gas wok hob, Miele **£460**
- CT400P tepan plate in stainless steel, Miele **£1,000**
- Futura island extractor in glass and stainless steel, Blanco by Gutmann **£4,900**
- Redonda island extractor in stainless steel, Blanco by Gutmann **£2,400**
- CVA4085SS built-in coffee machine, Miele **£1,350**

APPLIANCES (not shown)

- 2 x built-in warming drawers, Miele, each **£760**
- 2 x fully integrated larder fridges, Miele, each **£350**
- 2 x fully integrated dishwashers, Miele, each **£580**

☎ For stockists, see page 153

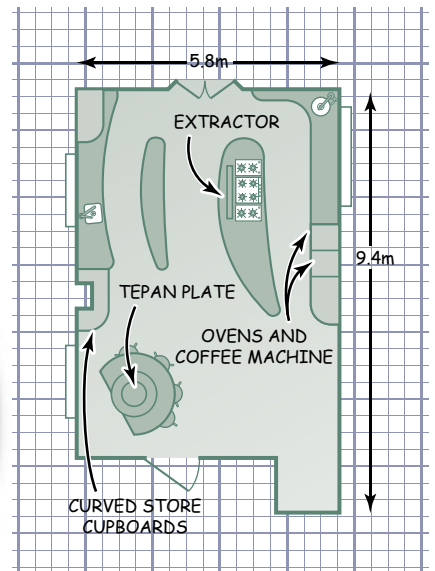

GUIDE PRICE

- Total cost, excluding appliances **£45,000**

▼ Light is such an intrinsic element of the Grants' scheme that even their Eve taps from KWC have LED lights built in. 'Colour and light are so important,' explains Jayne. 'Features such as the taps make our kitchen really different'



“My top tip for successful planning is not to let good looks sway you into buying second-rate appliances. They won't be as cost-effective as you'd think, so do plenty of research to avoid mistakes”

JAYNE GRANT